

Cove LED Bunker (Round Shape) Installation Guide

We strongly recommend that you read this manual carefully before installation.
Installation MUST be carried out by a qualified and licensed electrician.



Replacement
Warranty

Models Parameters

MLXCR34615S 15W IP54 Tricolour LED Bunker Round PIR Motion Sensor White

Installation Instructions

Step 1

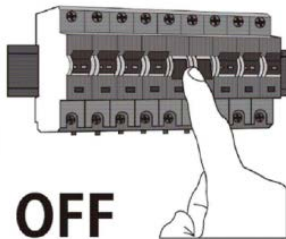

OFF

Switch off the mains

Step 2



Remove the diffuser

Step 3

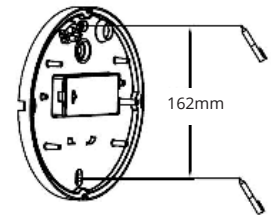

Mark on the desired mounting surface

Step 4

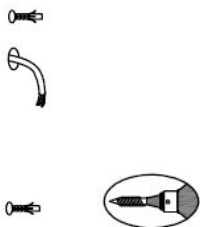

Drill holes and put the expansion nuts into the hole

Step 5

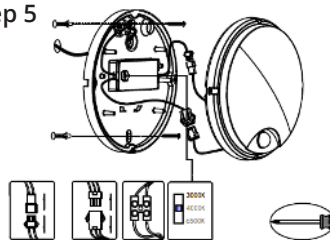

Mount the housing onto the wall, select desired CCT and connect to power as shown above, Plug both power and sensor connectors between housing and the light fitting.

Step 6

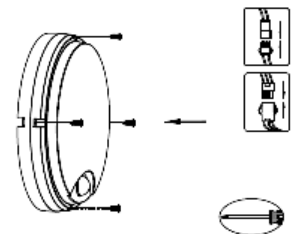

Put the diffuser back on

Step 7

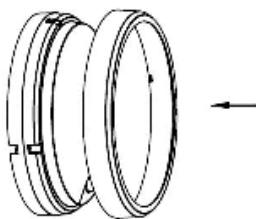

Put the ring (or trim) back on

Step 8

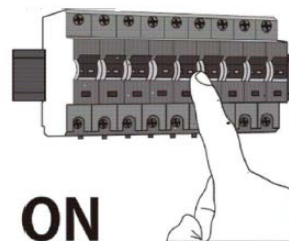

ON

Switch on the mains

Cove LED Bunker (Round Shape) Installation Guide

Data Table

Models	Power (W)	PF	CCT (K)	Weight (KG)	Operation Temperature (Degree)	IP	In-rush Current (A)
MLXCR34615S	15	≥0.5	3000 4000 6500	0.6	+40° -20°	54	5

Sensor Settings

SENS:

SENS controls the sensing distance of the sensor. When the KNOB is set to:-

- "+" (4m) = maximum sensing distance is reached
- "-" (1m) = minimum sensing distance is reached

TIME:

- TIME duration is adjustable from 3s (±1) to 8min (±1min)
- Turn this knob towards "+" (8mins) to increase the delay time
- Turn this knob towards "-" (3s) to decrease the delay time

LUX:

LUX controls the ambient light of the load lamp. When the KNOB is set to:-

- "Sun" position = Daytime.
The sensor detects the movement of the human body and triggers the light at night and day.
- "Moon" position = Evening.
The sensor detects the movement of the human body at night and triggers the light of the load.

NB: The sensor does not work during the day. Ambient illumination: 5 - 2000lux

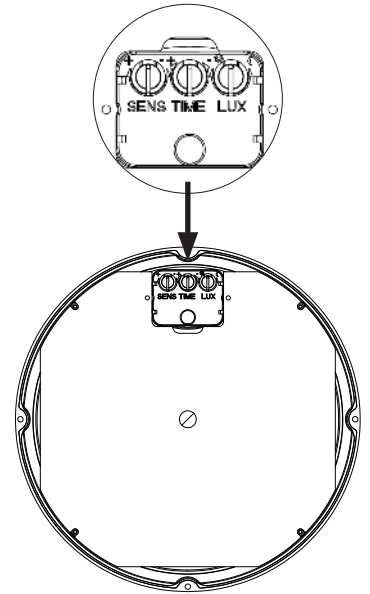

WARNING

- Installation of product **MUST** follow SAA standards and meet local authority regulations.
- Installation **MUST** be carried out by a qualified and licensed electrician.
- Light **MUST** be earthed.
- Light **MUST** be firmly installed to a flat solid surface, wall or ceiling.
- **DO NOT** immerse any part of the light fitting into water or any form of liquid.
- **DO NOT** look directly into the LED light.
- The warranty is **VOID** if product is not installed according to this installation guide.

2 Year Replacement Warranty

Visit our website for details <https://www.martecaustralia.com.au/warranty-statement/>

